



CEDARSCREEN:

From the earliest times in New Zealand as people searched for more durable materials, simple no nonsense timber weatherboards have been inextricably linked to the concept of good architecture.

Today's technically advanced cladding systems and enhanced profiling and machining methods, mean that cedar weatherboarding can be manipulated to exploit the full range of possibilities that timber provides.

A range of coating options and choice in texture create a myriad of opportunities for designers to draw from an extensive palette and create unique solutions for the wide range of landscape conditions that we encounter throughout the country.

MOAA ARCHITECTS



Rosenfeld Kidson



NOEL JESSOP ARCHITECTURE

Profile Chart



Email: rk@rosenfeldkidson.co.nz
 Web: www.rosenfeldkidson.co.nz

Auckland Branch:
 Telephone: +64 9 573 0503
 Fax: +64 9 573 0504
 513 Mount Wellington Highway
 Mount Wellington
 Auckland 1096

Christchurch Branch:
 Telephone: +64 3 349 3316
 Fax: +64 3 349 3317
 15 Edmonton Road
 Hornby
 Christchurch 8042

Postal Address:
 P O Box 621
 Shortland Street
 Auckland 1140



ACHILLES POINT LANDING PROJECT, ST HELIERS - VITEX

LANDSCAPING & HEAVY CONSTRUCTION:

From its early origins in the 1930's, Rosenfeld Kidson has been importing hardwoods from around the world for heavy construction and infrastructure projects, such as bridge, wharf and railway construction and hardwood poles and crossarms for power reticulation. However, there has been an increased demand for durable hardwoods for both domestic and commercial landscaping projects, as well as boardwalks around parks, reserves and waterfronts.



TAUPO LAKEFRONT DEVELOPMENT - TONKA

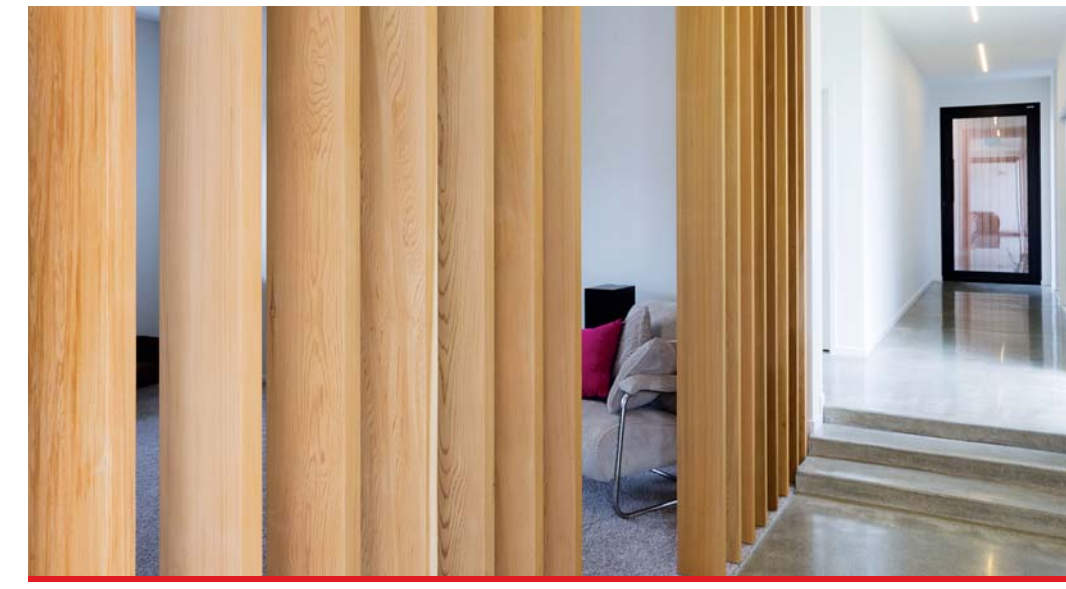

INTERIOR JOINERY, FURNITURE & BOATBUILDING:

Rosenfeld Kidson stocks more than 30 species of specialist timbers suitable for furniture manufacture, cabinetmaking, interior joinery and boatbuilding. Most of these species are available in 25, 40, 50 and 75mm thicknesses in a range of fixed or mixed widths.



NOEL JESSOP ARCHITECTURE



ANTANAS PROCUTA ARCHITECTS



FREEDOM FLOORING



EXTERIOR JOINERY & CONSTRUCTION:

Rosenfeld Kidson stocks a large range of specialist timbers for exterior joinery and construction. These include durable and stable softwoods such as Western Red Cedar for window and door joinery, exterior cladding and mouldings, as well as posts and beams for pergolas and the like.

Durable hardwoods are used in a kiln-dried condition for exterior joinery applications and as decking, handrails and pergolas. They are also used for more general construction in a green or air-dry condition.

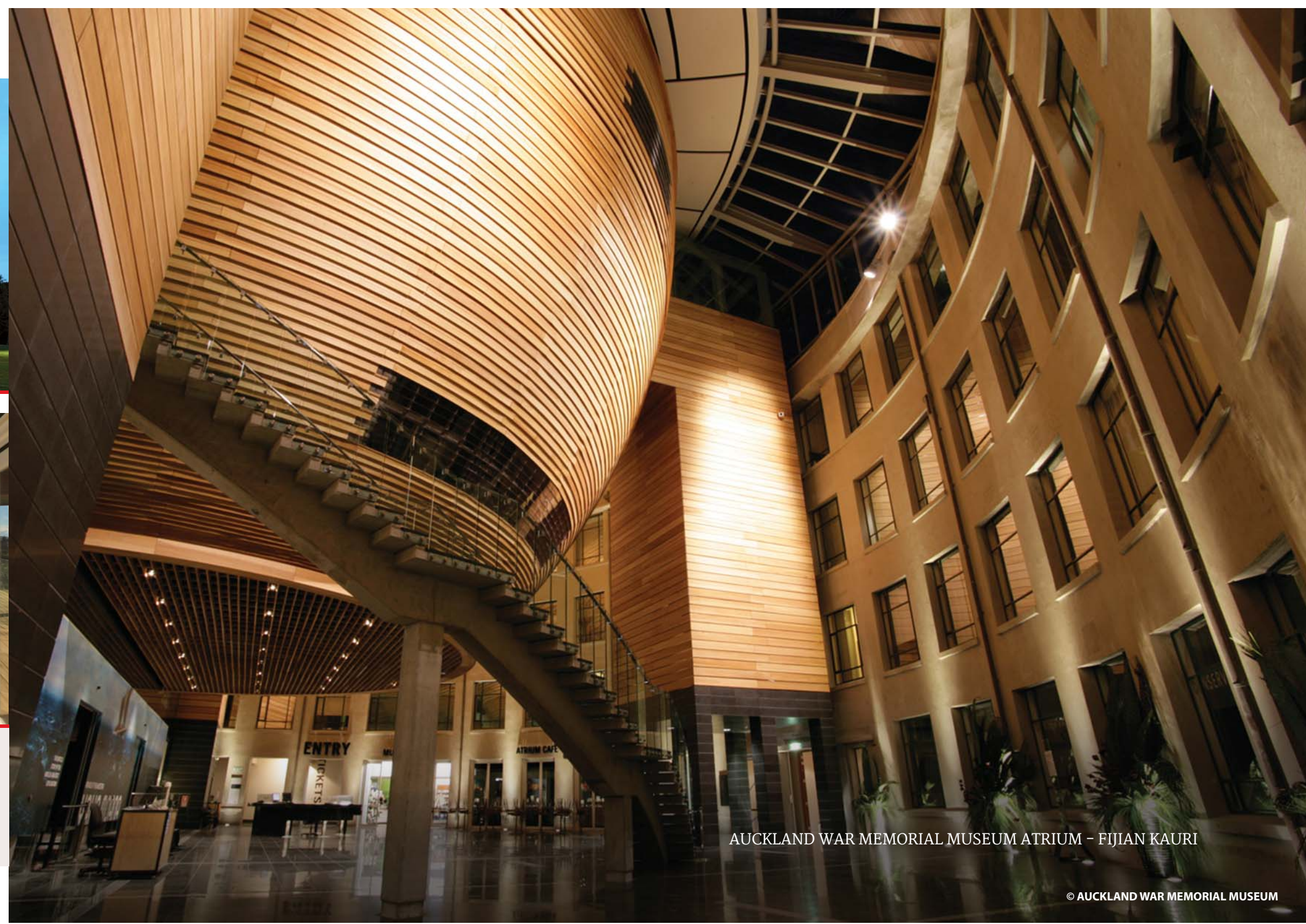

AUCKLAND WAR MEMORIAL MUSEUM ATRIUM - FIJIAN KAURI